

Attn Mark

Table Of Contents

Safety Is No Accident.....1
 Limited Warranty.....1
 Table Of Contents.....2
 Receipt Of Order.....2
 Specifications.....2
 Sign Off Sheet.....3
 Safety Notices.....4
 Grain Bin Safety.....5
 Assembly Instructions.....6-7
 Maintenance Check List.....2
 Instructions For Ordering Parts.....8
 Illustrated Parts List And Drawing.....8-9

Study this entire manual and familiarize yourself with the different parts of the My-D Han-D Utility Auger and their particular functions.

File this manual in a safe and convenient place for easy reference. Make it your guide for operating, lubricating and servicing your My-D Han-D Utility Auger.

Careful observance of these instructions can add to the life of your Utility auger parts and assure satisfactory performance.

Receipt Of Order

Upon receipt of order, check all parts against the packing list and examine for any evidence of damage. Notify the carrier and the distributor the auger was ordered from immediately of any discrepancy. Consignee must file claim for loss or damage with the delivering carrier.

	Specifications		* Electric Power Requirements			
	"600" UTILITY		"600" UTILITY		"800" UTILITY	
Length:	12' 17' 22' 27' 32' 34'	12' 17' 22' 27' 32' 34'	Length	Elec.	Length	Elec.
		37' 39' 42' & 47'				
	5 Ft. Extensions Available					
Tube Diameter:	6" Dia.	8" Dia.	12'	2 H.P.	12'	3 H.P.
Tube Thickness:	16 Ga.	14 Ga.	17'	2 H.P.	17'	5 H.P.
Auger Shaft:	.995" O.D. Tubing	1.495" O.D. Tubing	22'	3 H.P.	22'	5 H.P.
Flighting:	10 Ga.	10 Ga.	27'	3 H.P.	27'	7-1/2 H.P.
Auger Bearing:	1" Ball Bearing	1-5/16" Ball Bearing	32'	5 H.P.	32'	7-1/2 H.P.
Auger Speed:	550 RPM	445 RPM	34'	5 H.P.	34'	7-1/2 H.P.
Type Of Drive:	Electric	Electric	37'	7-1/2 H.P.	37'	10 H.P.
			39'	7-1/2 H.P.	39'	10 H.P.
			42'	7-1/2 H.P.	42'	10 H.P.
			44'	7-1/2 H.P.	44'	10 H.P.

Capacity

"600" UTILITY	"800" UTILITY
1750 Bu./Hr. Horizontal	3000 Bu./Hr. Horizontal
1000 Bu./Hr. @ 45 Deg	2000 Bu./Hr. @ 45 Deg.

* Variable, depending on type and condition of material and degree of elevation.

Note: Capacities and horsepower listed above are for dry grain.

All auger lengths over 32' must use an inlet sleeve to shut off the flow of grain prior to shutting the auger down.

Machine Inspection

After delivery of your new My-D Han-D Utility Auger, and or completion of assembly and before each use, inspection of the machine is mandatory. This inspection should include but not be limited to:

1. Check to see that all guards listed in the assembly instructions are in place, secured and functional.
2. Are all fasteners tight?
3. Are all belts properly adjusted?



Before starting assembly procedures, refer to the repair parts listing and familiarize yourself with these parts. Tools necessary for ease of assembly includes a socket wrench (impact if desired), vise grips, level and pliers. A means of lifting will be required for lifting the tube into place and for lifting the auger after it has been assembled.

Assemble The Utility Auger Drive Parts Using The Following Steps.

Before starting assembly procedures, refer to the parts listing and familiarize yourself with these parts before proceeding.

The 12' & 17" Utility Augers are shipped assembled, less motor, sheaves belts and guards.

Assembly Sequence

- A. Connect the upper and lower flighting sections (Fig. A) by sliding the lower tube down about 6 inches. Flighting sections should overlap about 2 to 3 inches before connecting.
("600" Utility) Connect with 5/16" x 1-1/2" HHCS and hex nuts.
("800" Utility) Connect with 3/8" x 2" HHCS and hex nuts.

- B. Bolt the flange rings together (Fig. A) using 3/8" x 1" HHCS and hex nut. Make certain flighting turns freely.

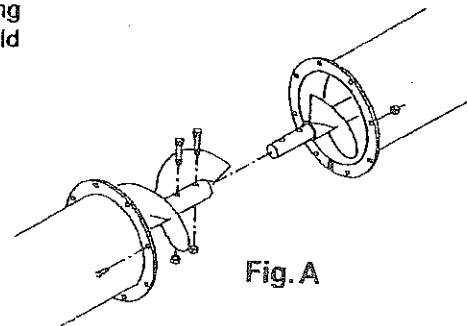
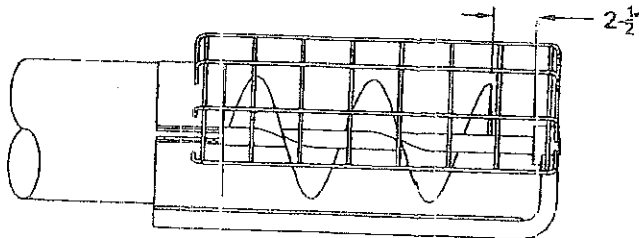

Make sure there is 2-1/2" of clearance between inside of cage and the end of the flighting.
See drawing above.

- C. Mount the electric motor on motor mount with the shaft extended to the front center motor and bolt to motor mount with 3/8" x 1-1/2" HHCS, flat washer, and hex nuts. Note: have qualified electrician connect wiring, starters, etc.
- D. Install the 12" OD 2-B sheave ("600" Utility), 15" OD 2-B Sheave ("800" Utility) on flighting shaft and secure with key and setscrew.
- E. Install the 3.6" P.D. 2-B sheave ("600" Utility), 3.6" P.D. 2-B sheave ("800" Utility) on motor shaft and secure with key and setscrew.
- F. Install two (2) B-48 V-belts ("600" Utility), two (2) B-57 V-belts ("800" Utility). Align belts by moving motor forward or reverse and lock the setscrew on the motor mount slide.
The V-belt tension is adjusted by the four threaded legs on the motor mount base.
Adjust to approximately 7 to 10 pounds tension (5/8" deflection).
- G. Install belt guard as shown in the illustrations.
NOTE: Flat washers are used on all slots.

"600 Belt Guard Installation"

1. Assemble end cover (C) to belt guard body (B) using 1/4" x 1/2" HHCS and hex nuts. See illustration for 6".
2. Attach belt guard strap (D) to front support bracket (E) using 5/16" x 3/4" HHCS, center lock nuts, and flat washers. See illustration for 6".
3. Attach L-bracket (F) to motor mount slide (G) using 5/16" x 1" HHCS, two flat washers, and hex nut.
4. Attach belt guard body (B) to belt guard strap (D) using two #14 x 3/4" self tapping screws and 5/16" flat washers.
5. Attach L-bracket (F) to belt guard body (B) using 5/16" x 3/4" HHCS, flat washer, and nut.

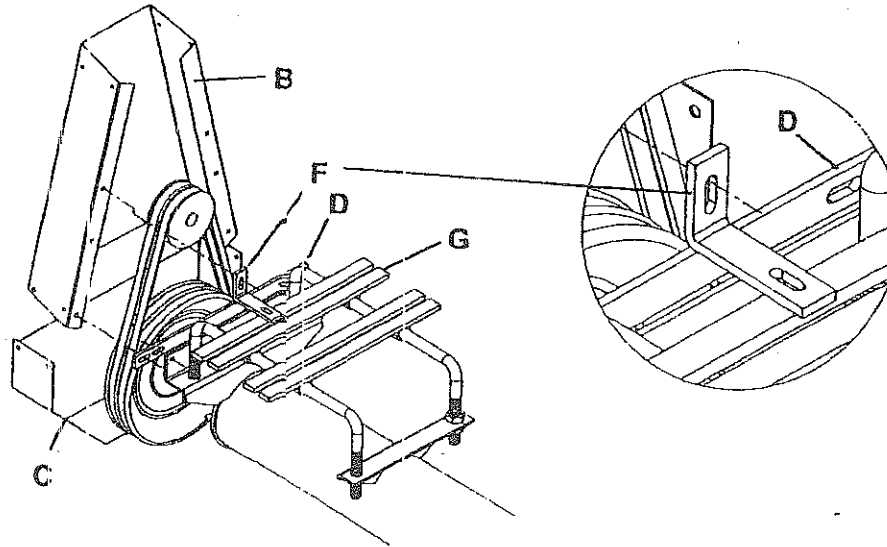

"800 Belt Guard Installation"

1. Assemble end cover (A) to belt guard body (B) using 1/4" x 1/2" HHCS and hex nut.
2. Attach belt guard (B) to front support bracket (C) using 5/16" x 3/4" HHCS, flat washers, and nuts.

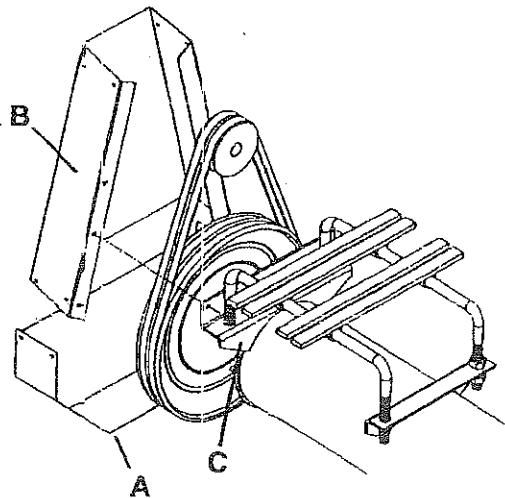

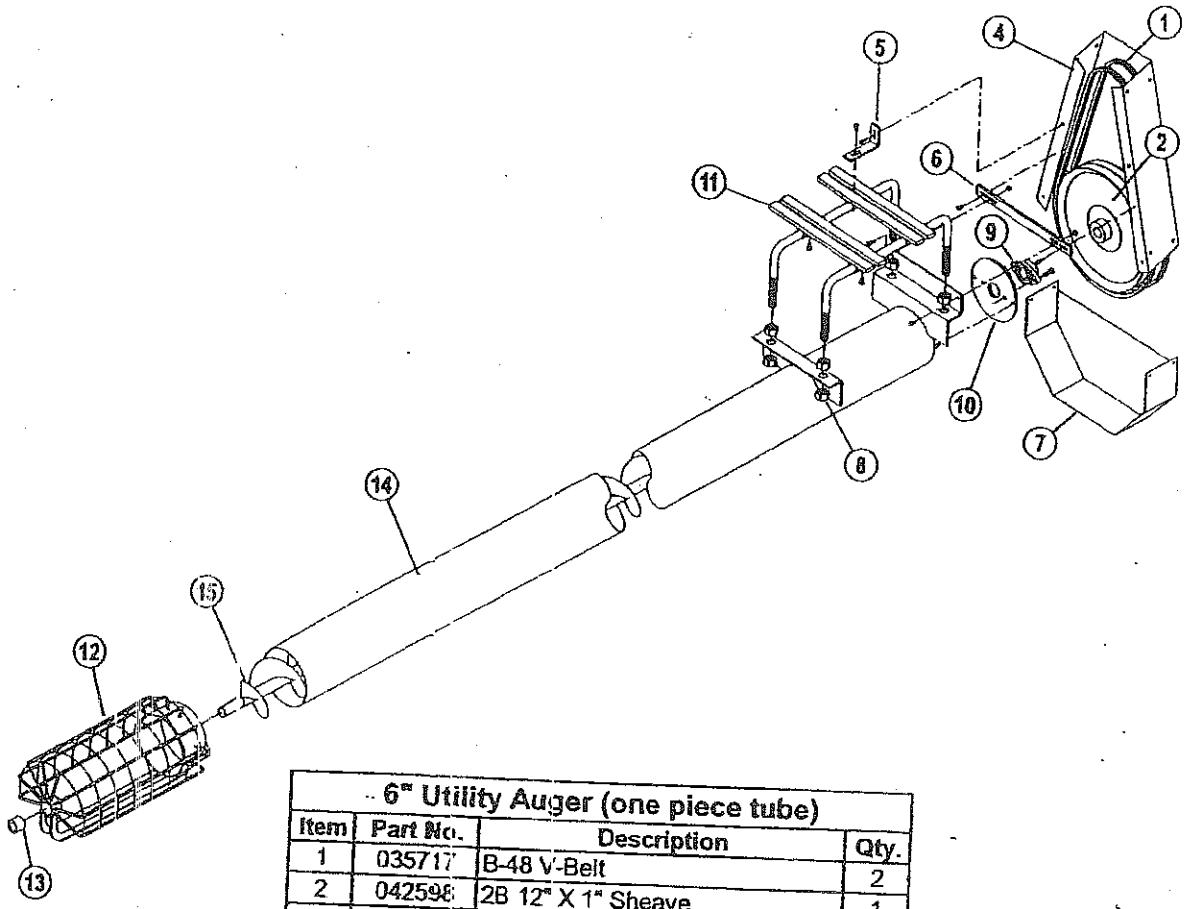

6" Utility Auger (one piece tube)

Item	Part No.	Description	Qty.
1	035717	B-48 V-Belt	2
2	042598	2B 12" X 1" Sheave	1
3	720482	Bolt Sack (not shown)	1
4	150675	Belt Guard Body	1
5	166553	Belt Guard Bracket	1
6	166561	Belt Guard Strap	1
7	826826	End Cover	1
8	015271	3/4" Hex Nut	8
9	030015	1" Flange Mount Bearing	1
10	124784	Head Plate	1
11	814384	Motor Mount	1
12	826883	6" Cage	1
13	121723	Bronze Bushing	1
14	816074	12' Utility Tube Weldment	1
	816066	17' Utility Tube Weldment	1
	816058	22' Utility Tube Weldment	1
15	816462	12' Utility Flighting	1
	816454	17' Utility Flighting	1
	816082	22' Utility Flighting	1

INSTRUCTIONS FOR ORDERING REPAIR PARTS

1. Order from your My-D Han-D Distributor or Dealer.
2. Be sure to give part no. and description as it is written in the list accompanying each illustration of parts. (Do not use item number.)
3. Be specific regarding shipping information.
4. Part description tells if more than one of the parts is used.

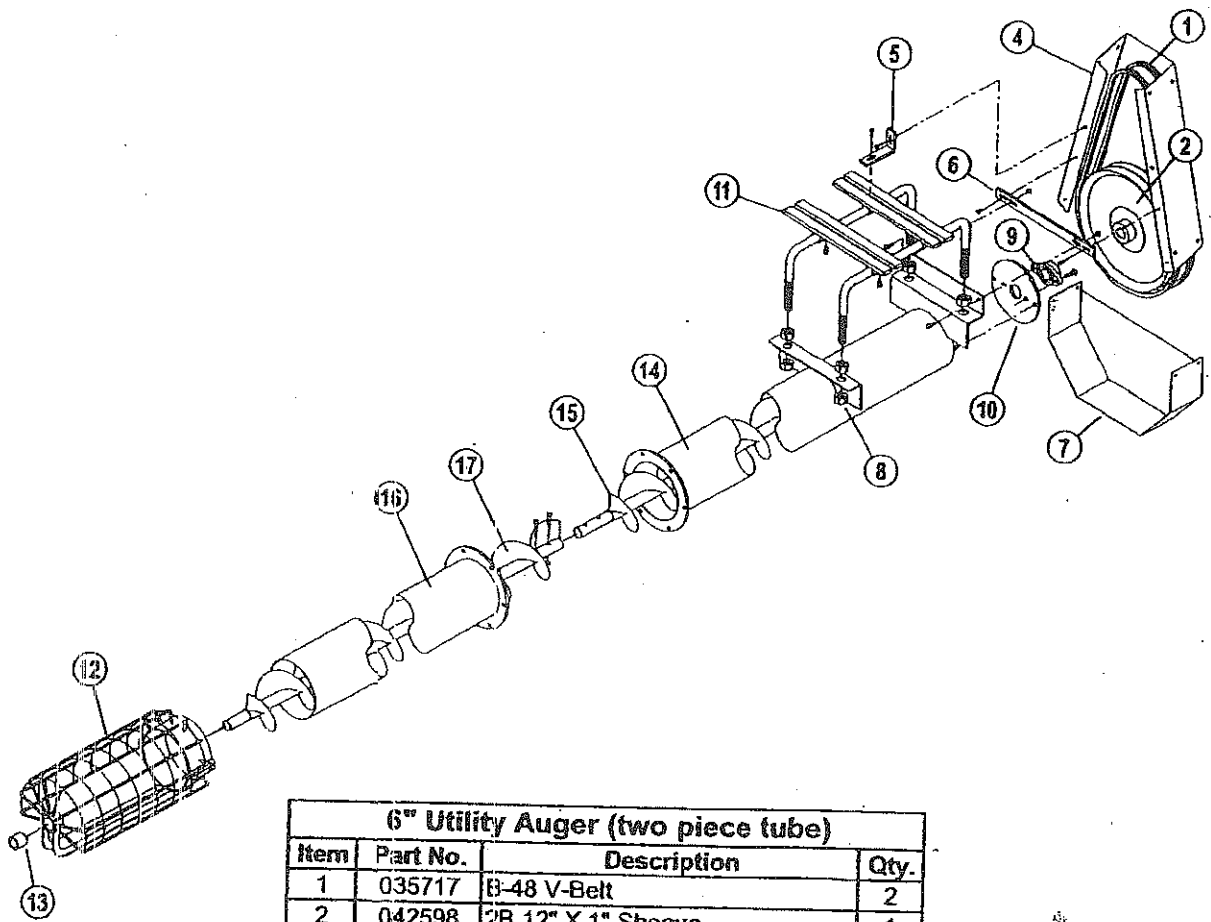

6" Utility Auger (two piece tube)			
Item	Part No.	Description	Qty.
1	035717	B-48 V-Belt	2
2	042598	2B 12" X 1" Sheave	1
3	720482	Bolt Sack (not shown)	1
4	150615	Belt Guard Body	1
5	166553	Belt Guard Bracket	1
6	166561	Belt Guard Strap	1
7	826826	End Cover	1
8	015271	3/4" Hex Nut	8
9	030015	1" Flange Mount Bearing	1
10	124784	Head Plate	1
11	814384	Motor Mount	1
12	826883	6" Cage	1
13	121723	Bronze Bushing	1
14	821876	5' Top Utility Tube Weldment	1
	816074	12' Top Utility Tube Weldment	1
15	821728	5' Upper Utility Flighting	1
	816462	12' Upper Utility Flighting	1
16	821926	19' Lower Utility Tube Weldment	1
17	821694	19' Lower Utility Flighting	1

INSTRUCTIONS FOR ORDERING REPAIR PARTS

1. Order from your My-D Han-D Distributor or Dealer.
2. Be sure to give part no. and description as it is written in the list accompanying each illustration of parts. (Do not use item number.)
3. Be specific regarding shipping information.
4. Part description tells if more than one of the parts is used.

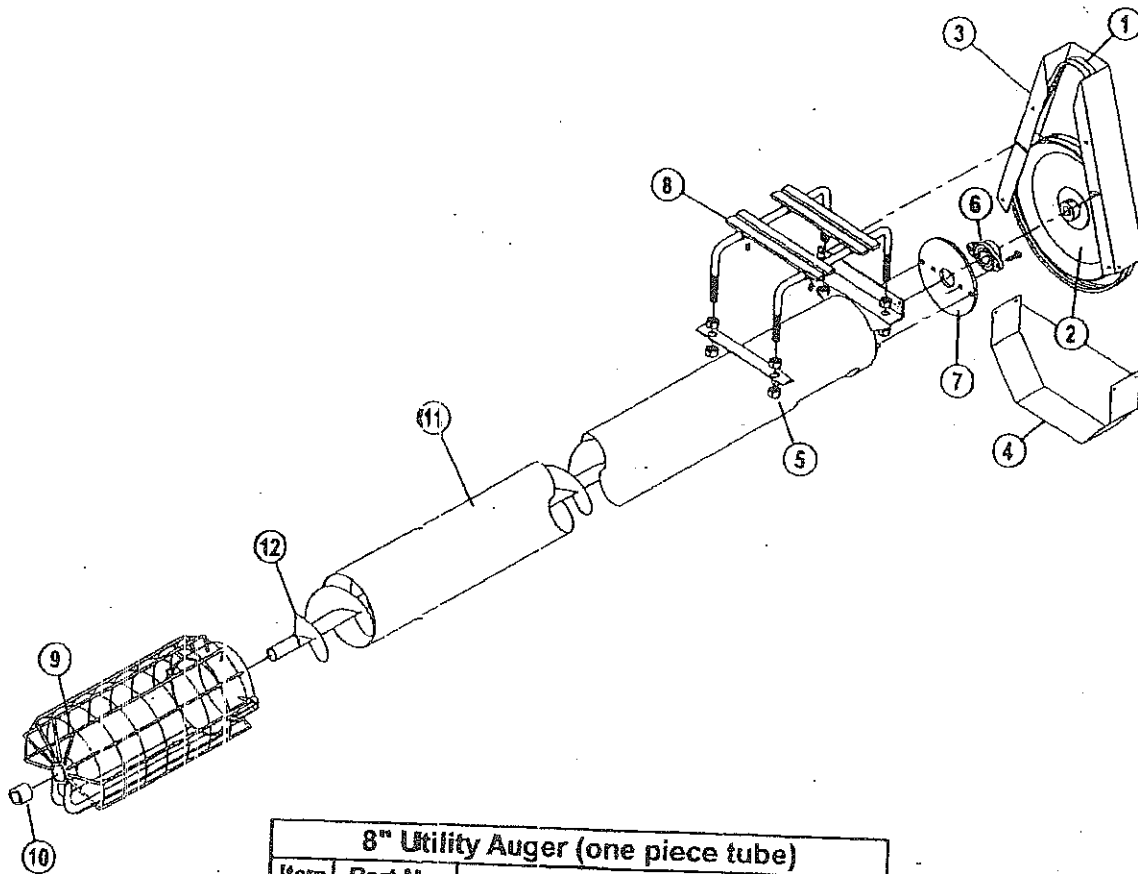

8" Utility Auger (one piece tube)			
Item	Part No.	Description	Qty.
1	035170	B-57 V-Belt	2
2	042754	2B 15 X 1-5/16" Sheave	1
3	158444	Belt Guard Body	1
4	830679	Belt Guard End Cover	1
5	015271	3/4" Hex Nut	8
6	030189	1- 5/16" Flange Mount Bearing	1
7	124750	Head Plate	1
8	817049	Motor Mount	1
9	826875	Cage	1
10	129395	Bronze Bushing	1
11	817031	12' Utility Tube Weldment	1
	816926	17' Utility Tube Weldment	1
	816892	22' Utility Tube Weldment	1
12	816678	12' Utility Flighting	1
	816694	17' Utility Flighting	1
	816710	22' Utility Flighting	1
13	720490	Bolt Sack (not shown)	1

INSTRUCTIONS FOR ORDERING REPAIR PARTS

1. Order from your My-D Han-D Distributor or Dealer.
2. Be sure to give part no. and description as it is written in the list accompanying each illustration of parts. (Do not use item number.)
3. Be specific regarding shipping information.
4. Part description tells if more than one of the parts is used.

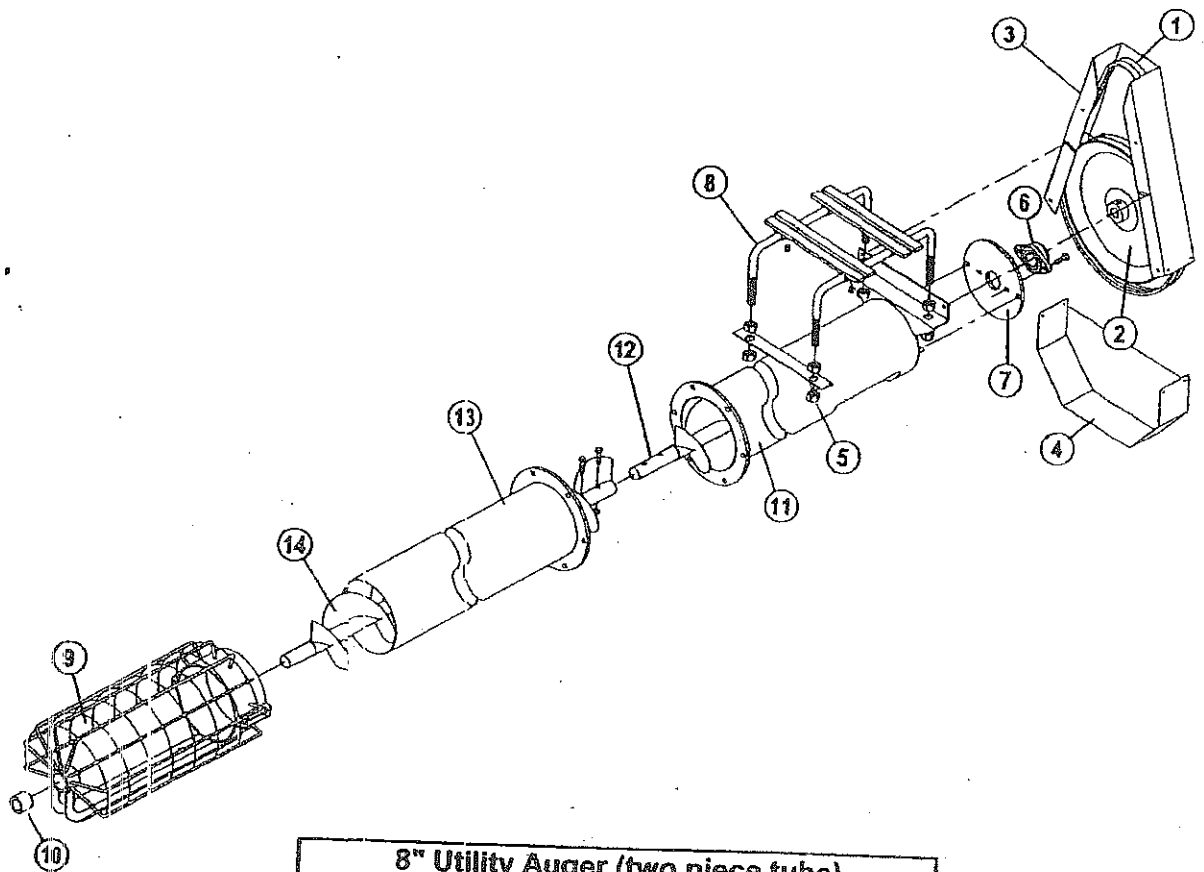

8" Utility Auger (two piece tube)			
Item	Part No.	Description	Qty.
1	035170	B-57 V-Belt	2
2	042754	2B 15 X 1-5/16" Sheave	1
3	158444	Belt Guard Body	1
4	830679	Belt Guard End Cover	1
5	015271	3/4" Hex Nut	8
6	030189	1- 5/16" Flange Mount Bearing	1
7	124750	Head Plate	1
8	817049	Motor Mount	1
9	826875	Cage	1
10	129395	Bronze Bushing	1
11	816884	5' Top Utility Tube Weldment	1
	821892	12' Top Utility Tube Weldment	1
12	821397	5' Upper Utility Flighting	1
	816678	12' Upper Utility Flighting	1
13	821934	19' Lower Tube Weldment	1
14	822056	19' Lower Flighting	1
15	720490	Bolt Sack	1

INSTRUCTIONS FOR ORDERING REPAIR PARTS

1. Order from your My-D Han-D Distributor or Dealer.
2. Be sure to give part no. and description as it is written in the list accompanying each illustration of parts. (Do not use item number.)
3. Be specific regarding shipping information.
4. Part description tells if more than one of the parts is used.

Flex Spout (optional)			
Item	Part No.	Description	Qty.
1	711887	6" Discharge Spout w/ Band	1
	711895	8" Discharge Spout w/ Band	1
2	899492	3' Flex Spout "600"	1
	899518	5' Flex Spout "600"	
	899534	8' Flex Spout "600"	
	899484	3' Flex Spout "800"	1
	899500	5' Flex Spout "800"	1
	899526	8' Flex Spout "800"	1
3	136291	6" Half Band	1
	136283	8" Half Band	1

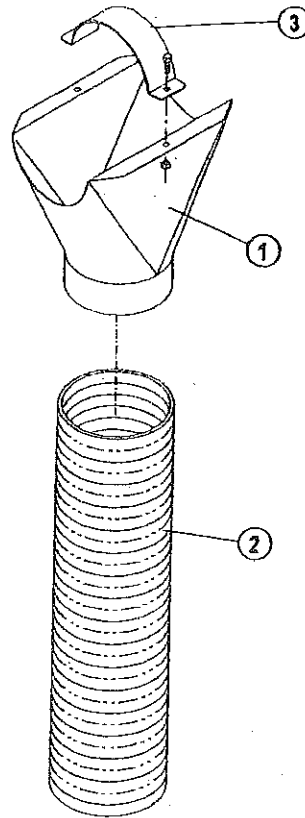

902577 5' "600" Utility Extension			
Item	Part No.	Description	Qty.
1	122697	6" Splice Band	2
2	821306	Flighting Weldment, 5'	1
3	000588	Tube, 5'	1

902585 5' "800" Utility Extension			
Item	Part No.	Description	Qty.
1	132753	8" Splice Band	2
2	821397	Flighting Weldment, 5'	1
3	000604	Tube, 5'	1

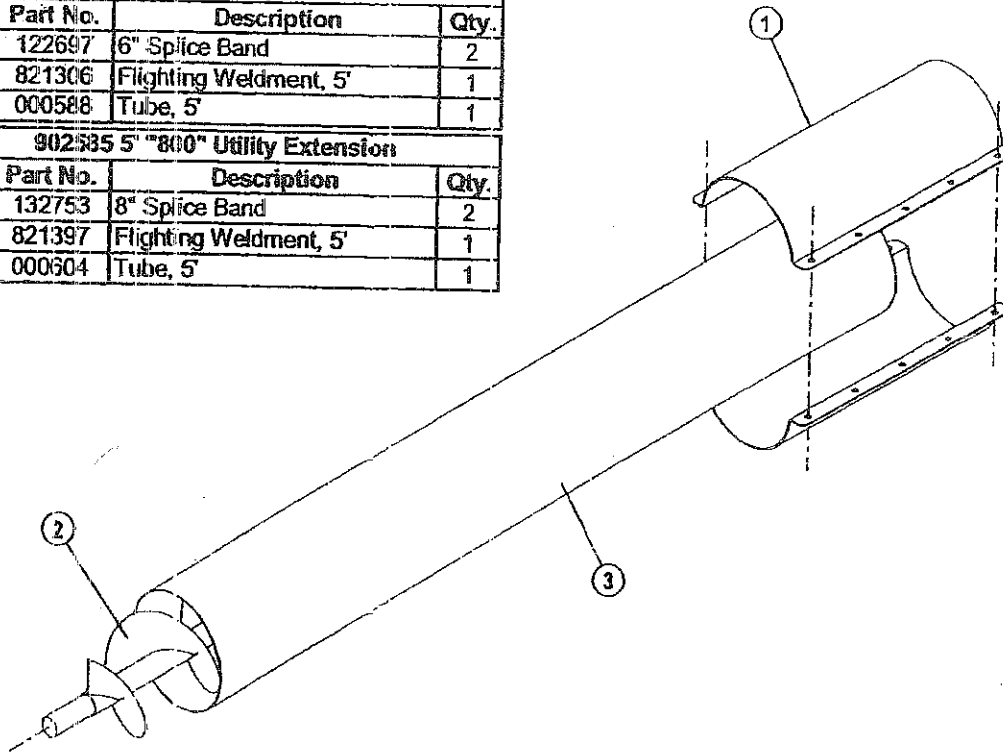

Part No	Description		
730119	"600" - Hanger Bearing Assembly		
Item	Part No	Description	Qty
1	833517	Tube Weldment	1
2	165233	Stub Shaft	1
3	031088	Grease Bolt	1
4	030494	Hanger Bearing	1
5	165191	Bronze Bushing	1
6	730051	Hanger Bearing Assembly	1
730127	"800" - Hanger Bearing Assembly		
Item	Part No	Description	Qty
1	833525	Tube Weldment	1
2	165241	Stub Shaft	1
3	031088	Grease Bolt	1
4	030486	Hanger Bearing	1
5	165209	Bronze Bushing	1
6	730069	Hanger Bearing Assembly	1

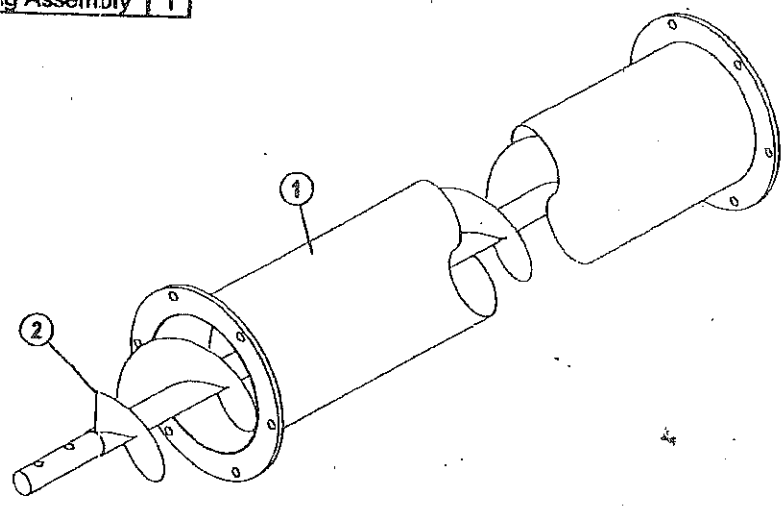
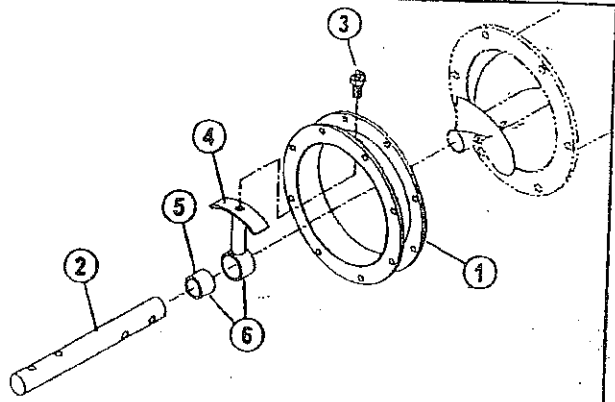

Part No	Description		
730176	"600" - 5' Mid Tube Bundle includes the following		
Item	Part No	Description	Qty
1	833566	5' Mid Tube Weldment	1
2	833590	5' Flighting Weldment	1
730143	"600" - 10' Mid Tube Bundle includes the following		
1	833533	10' Mid Tube Weldment	1
2	833582	10' Flighting Weldment	1
670992	"600" - 19' Mid Tube Bundle includes the following		
1	830986	19' Mid Tube Weldment	1
2	821710	19' Flighting Weldment	1
730218	"800" - 5' Mid Tube Bundle includes the following		
1	833574	5' Mid Tube Weldment	1
2	833616	5' Flighting Weldment	1
720862	"800" - 10' Mid Tube Bundle includes the following		
1	833459	10' Mid Tube Weldment	1
2	833442	10' Flighting Weldment	1
680140	"800" - 19' Mid Tube Bundle includes the following		
1	830794	19' Mid Tube Weldment	1
2	822080	19' Mid Flighting Weldment	1

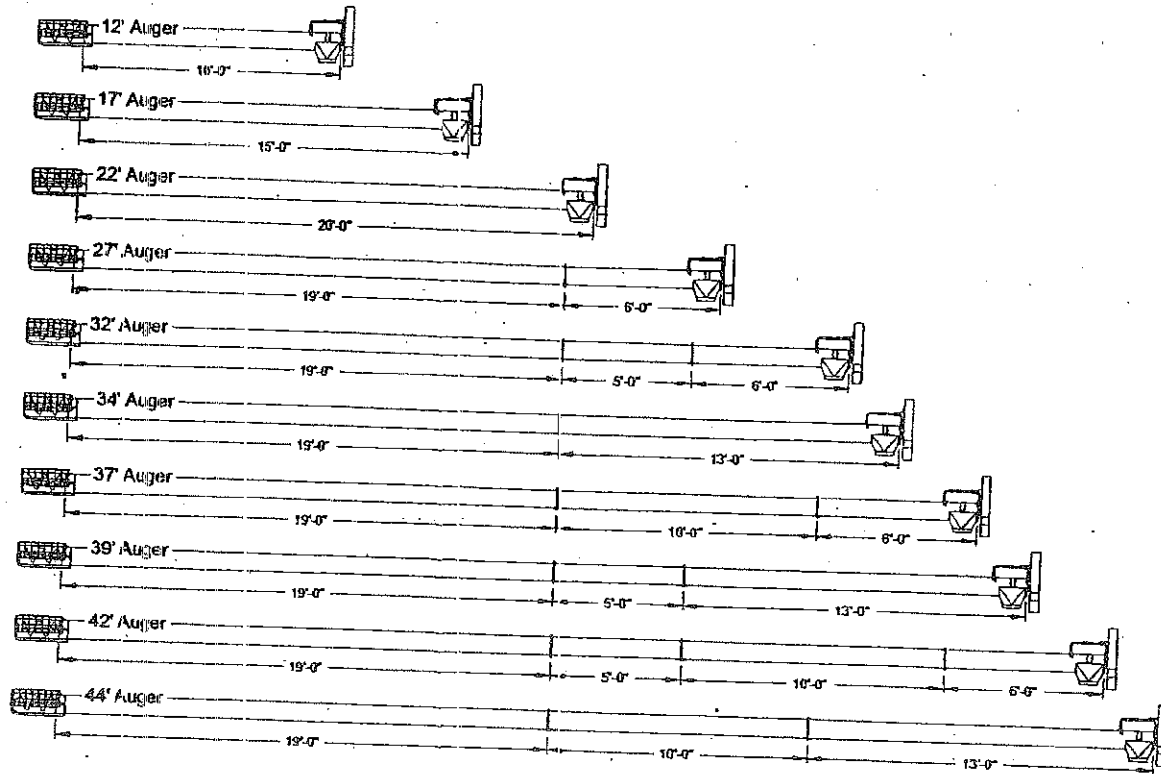

Part No	Description	Qty	Part No	Description	Qty
900415	12' "800" - Auger assembly - includes the following	1	900571	12' "600" - Auger assembly - includes the following	1
	12' Tube Assembly	1		12' Tube Assembly	1
900423	17' "800" - Auger assembly - includes the following	1	900589	17' "600" - Auger assembly - includes the following	1
	17' Tube Assembly	1		17' Tube Assembly	1
900431	22' "800" - Auger assembly - includes the following	1	900597	22' "600" - Auger assembly - includes the following	1
	22' Tube Assembly	1		22' Tube Assembly	1
900449	27' "800" - Auger assembly - includes the following	1	900605	27' "600" - Auger assembly - includes the following	1
	19' Bottom Tube Assembly	1		19' Bottom Tube Assembly	1
	5' Top Tube Assembly	1		5' Top Tube Assembly	1
900456	32' "800" - Auger assembly - includes the following	1	900613	32' "600" - Auger assembly - includes the following	1
	19' Bottom Tube Assembly	1		19' Bottom Tube Assembly	1
	5' Mid Tube Assembly	1		5' Mid Tube Assembly	1
	6' Top Tube Assembly	1		6' Top Tube Assembly	1
900514	34' "800" - Auger assembly - includes the following	1	900480	34' "600" - Auger assembly - includes the following	1
	19' Bottom Tube Assembly	1		19' Bottom Tube Assembly	1
	13' Top Tube Assembly	1		13' Top Tube Assembly	1
900464	37' "800" - Auger assembly - includes the following	1	900621	37' "600" - Auger assembly - includes the following	1
	19' Bottom Tube Assembly	1		19' Bottom Tube Assembly	1
	10' Mid Tube Assembly	1		10' Mid Tube Assembly	1
	6' Top Tube Assembly	1		6' Top Tube Assembly	1
900522	39' "800" - Auger assembly - includes the following	1	900498	39' "600" - Auger assembly - includes the following	1
	19' Bottom Tube Assembly	1		19' Bottom Tube Assembly	1
	5' Mid Tube Assembly	1		5' Mid Tube Assembly	1
	13' Top Tube Assembly	1		13' Top Tube Assembly	1
900472	42' "800" - Auger assembly - includes the following	1	900314	42' "600" - Auger assembly - includes the following	1
	19' Bottom Tube Assembly	1		19' Bottom Tube Assembly	1
	5' Mid Tube Assembly	1		5' Mid Tube Assembly	1
	10' Mid Tube Assembly	1		10' Mid Tube Assembly	1
	6' Top Tube Assembly	1		6' Top Tube Assembly	1
900530	44' "800" - Auger assembly - includes the following	1	900506	44' "600" - Auger assembly - includes the following	1
	19' Bottom Tube Assembly	1		19' Bottom Tube Assembly	1
	10' Mid Tube Assembly	1		10' Mid Tube Assembly	1
	13' Top Tube Assembly	1		13' Top Tube Assembly	1